

Housing - HC-D 7-SMLGE-26/O1M20 - 1411759

Please be informed that the data shown in this PDF Document is generated from our Online Catalog. Please find the complete data in the user's documentation. Our General Terms of Use for Downloads are valid (<http://phoenixcontact.com/download>)



Box mounting bases D7, with single locking latch, material: Zinc die-cast, cable outlets: 1, lateral, height: 25.5 mm, cable gland: none, support sleeve: yes, 1x M20, Standard, enclosed bottom



Key Commercial Data

Packing unit	10 STK
GTIN	
GTIN	4046356940276

Technical data

Dimensions

Height	25.5 mm
Width	40.5 mm
Length	38 mm

Ambient conditions

Degree of protection of housing (IP)	IP54
	IP65 (with sealing screw)
Ambient temperature (operation)	-40 °C ... 125 °C

General

Note	for contact inserts HC-D7, D8, A3, A4, B5, HS2-D7
Size	D7
Housing type	Box mounting bases
Locking type	with single locking latch
No. of cable outlets	1
Cable outlet	lateral
Screw connection	none
Type of the screw connection	1x M20
Housing material	Zinc die-cast

Housing - HC-D 7-SMLGE-26/O1M20 - 1411759

Technical data

General

Housing surface material	Powder-coated, gray
Seal material	NBR
Material lock	Steel, galvanized
Assembly instructions	Connectors may be operated only when there is no load/voltage.

Environmental Product Compliance

China RoHS	Environmentally friendly use period: unlimited = EFUP-e
	No hazardous substances above threshold values

Drawings

Dimensional drawing

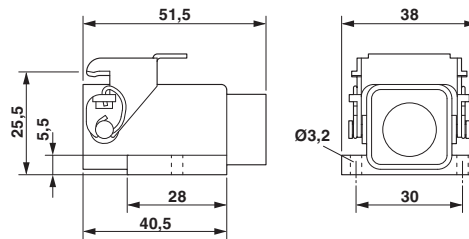

Phoenix Contact 2018 © - all rights reserved
<http://www.phoenixcontact.com>

PHOENIX CONTACT GmbH & Co. KG
Flachsmarktstr. 8
32825 Blomberg
Germany
Tel. +49 5235 300
Fax +49 5235 3 41200
<http://www.phoenixcontact.com>