

THIS DRAWING IS A CONTRACT DOCUMENT. IT IS SUBJECT TO CHANGE WITH THE APPROVAL OF AMP INC. IT IS SUBJECT TO CHANGE WITH THE APPROVAL OF AMP INC. IT IS SUBJECT TO CHANGE WITH THE APPROVAL OF AMP INC. IT IS SUBJECT TO CHANGE WITH THE APPROVAL OF AMP INC.

THIS INFORMATION IS CONFIDENTIAL AND IS DISCLOSED TO YOU ON CONDITION THAT YOU WILL NOT DISCLOSE IT TO ANY OTHER PERSON OR ENTITY WITHOUT THE WRITTEN AUTHORIZATION OF AMP INC. OR ITS AFFILIATES. AMP INC. AND ITS AFFILIATES ARE NOT RESPONSIBLE FOR ANY REPRODUCTION OF THIS INFORMATION.

AMP 3076-2 (8-73) \* Trademark of AMP Incorporated

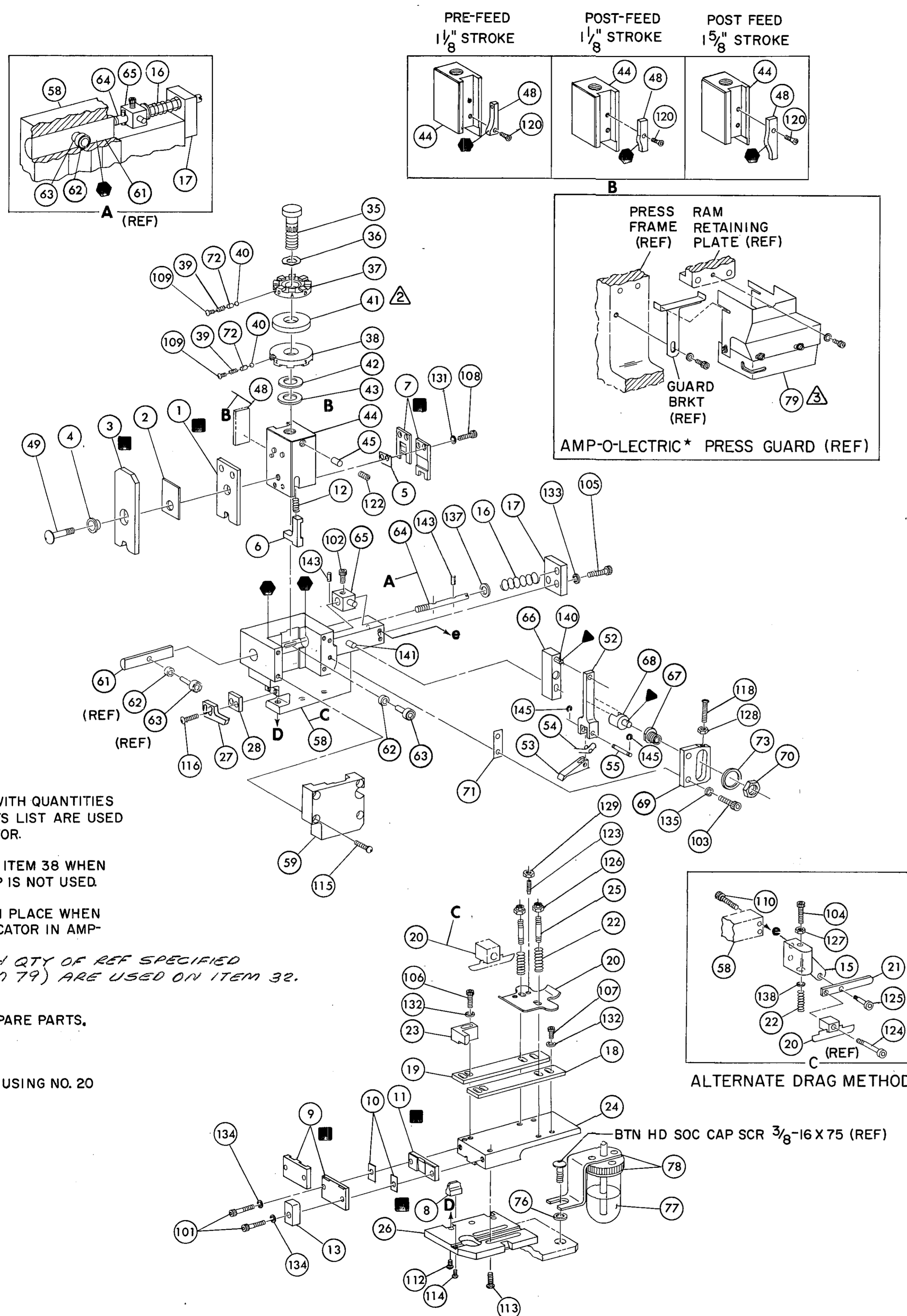

- NOTES:**
- 1. ONLY THE ITEMS WITH QUANTITIES SPECIFIED ON PARTS LIST ARE USED ON THIS APPLICATOR.
  - 2. USED IN PLACE OF ITEM 38 WHEN INSULATION CRIMP IS NOT USED.
  - 3. GUARD MUST BE IN PLACE WHEN OPERATING APPLICATOR IN AMP-O-LECTRIC PRESS.
  - 4. PARTS WITH QTY OF REF SPECIFIED (EXCEPT ITEM 79) ARE USED ON ITEM 32.
- KEY:**
- RECOMMENDED SPARE PARTS.
  - ▲ LUBRICATE DAILY USING NO. 20 MACHINE OIL.
  - GREASE LIGHTLY.

ALTERNATE DRAG METHOD

REF	QTY	PART NO	DESCRIPTION	ITEM NO	REF	QTY	PART NO	DESCRIPTION	ITEM NO
		21045-3	RING, RETAINING 'C' (.187 DIA) FEED PIN	145	REF	454220-1	CAP, RAM	59	
		REF		144	REF	453736-1	HOUSING	58	
		5-21028-1	PIN, SLOT SPG (.12 DIA X .50) FD ADJ ROD	143				57	
				142				56	
		REF	1-21030-7	PIN, DOWEL (.187 DIA X 1.50) HOUSING	141	REF	240624-1	PIN, FEED FINGER	55
		REF	1-21030-1	PIN, DOWEL (.187 DIA X .50) LEVER	140	REF	691499-1	SPRING, FEED FINGER	54
				139	REF	240635-1	FINGER, FEED	53	
		22260-5	WASHER, FLAT (NO 6) DRAG SPRING	138	REF	240634-1	LEVER, TERMINAL	52	
		REF	21899-4	WASHER, FLAT (5/16 DIA) SCR ADJ	137			51	
				136				50	
		REF	21024-5	WASHER, LOCK (NO 10) FEED ADJ PLATE	135	1	7-21002-9	BOLT, CRIMPER	49
		2	21024-5	WASHER, LOCK (NO 10) SHEAR PLATES	134	1	690602-5	CAM, PRE FEED 1 1/8 STROKE	48
		REF	21024-5	WASHER, LOCK (NO 10) FEED ROD GUIDE	133			47	
		5	21024-4	WASHER, LOCK (NO 8) STRIP GUIDE	132			46	
		2	21024-4	WASHER, LOCK (NO 8) SHEAR BLADE	131	1	690191-1	PLUG, NYLON	45
				130	1	455674-1	RAM	44	
		2	21018-4	NUT, HEX MACH (4-40) DRAG	129	1	690125-1	WASHER, LAMINATED	43
		REF	21068-5	NUT, HEX MACH (6-32) FD ADJ PLATE	128	1	690124-1	WASHER, RAM	42
			21018-7	NUT, HEX MACH (10-32) DRAG SPRING	127			SPACER, DISC	41
		2	21022-2	NUT, HEX SELF-LKG (8-32) DRAG STUD	126	2	23241-6	BALL, STEEL	40
			5-21004-7	SCR, SKT HD SHLD (250 DIA X .25) DRAG ARM	125	2	690170-1	SPRING, COMPRESSION	39
			21004-5	SCR, SKT HD SHLD (250 DIA X 1.00) DRAG	124	1	690142-1	DISC, INSULATION	38
		2	4-21078-8	SCR, SKT SET OVAL POINT (4-40 X .75) DRAG	123	1	4-690141-9	DISC, WIRE	37
		1	21009-2	SCR, SKT SET (1/4-20 X 25) (LOC-WEL) RAM	122	1	22480-5	WASHER, SPRING	36
				121	1	690212-1	POST, RAM	35	
		1	2-21003-0	SCR, FLAT HD SKT CAP (6-32 X .50) CAM	120			34	
				119				33	
		REF	3-21064-2	SCR, RD HD MACH (6-32 X 1.50) FEED ADJ	118	1	458980-1	APPLICATOR, BASIC (SUB ASSY)	32
				117				31	
		2	2-21002-2	SCR, BTN HD SKT CAP (8-32 X .50) STRIPPER	116			30	
		REF	2-21002-9	SCR, BTN HD SKT CAP (10-32 X .75) HSG CAP	115			29	
		1	22733-8	SCR, BTN HD SKT CAP (8-32 X .38) (LOC-WEL) ANVIL	114	1	3-690451-2	SPACER, STRIPPER	28
		4	3-21002-3	SCR, BTN HD SKT CAP (1/4-20 X .50) STR GDE PL	113	1	240639-1	STRIPPER	27
		REF	1-24073-9	SCR, BTN HD SKT CAP (1/4-20 X .75) BASE PL	112	REF	455676-1	PLATE, BASE	26
				111	2	22354-8	DRAG, STUD	25	
			2-21000-4	SCR, SKT HD CAP (6-32 X 1.00) DRAG ADAPTOR	110	1	455678-1	PLATE, STRIP GUIDE	24
		2	23030-1	SCR, SKT HD CAP (6-32 X .25) (LOC-WEL) CP DISC	109	1	240825-6	PLATE, STRIP HOLD	23
		2	2-21000-7	SCR, SKT HD CAP (8-32 X .50) SHEAR BLADE	108	2	4-22281-1	SPRING, DRAG	22
		3	7-21000-4	SCR, SKT HD CAP (8-32 X .31) STRIP GUIDE	107		240636-1	LEVER, DRAG	21
		2	2-21000-8	SCR, SKT HD CAP (8-32 X .62) STRIP GUIDE	106	1	454177-1	DRAG, STOCK	20
		REF	3-21000-7	SCR, SKT HD CAP (10-32 X .75) FD ROD GUIDE	105	1	454204-7	GUIDE, STRIP (REAR)	19
			3-21000-9	SCR, SKT HD CAP (10-32 X 1.00) DRAG SPRING	104	1	454204-7	GUIDE, STRIP (FRONT)	18
		REF	3-21000-6	SCR, SKT HD CAP (10-32 X .62) FD ADJ PLATE	103	REF	454178-1	GUIDE, FEED ROD	17
		REF	3-21000-4	SCR, SKT HD CAP (10-32 X .38) PIVOT BLK	102	REF	4-22284-9	SPRING, FEED RETURN	16
		2	3-21000-8	SCR, SKT HD CAP (10-32 X .88) SHEAR PLATE	101			ADAPTER, DRAG	15
		REF	455745-1	GUARD	79			14	
			465184-9	LUBRICATOR ASSY	78	1	690481-2	SPACER, HOLD DOWN	13
			455985-1	OIL, LUBRICATING	77	1	23846-1	SPRING, HOLD DOWN	12
			454406-1	SPACER, LUB BRACKET	76	1	240644-1	PLATE, REAR SHEAR	11
				75			SPACER, SHEAR PLATE	10	
				74	1	690482-6	PLATE, FRONT SHEAR	9	
		REF	458109-1	WASHER, FLAT (SPECIAL)	73	1	9-240693-3	ANVIL	8
		2	690603-1	SPRING, ASSIST	72	1	690474-6	BLADE, SLUG	7
		REF	690517-1	SPACER	71	1	3-455892-4	HOLD DOWN, TERMINAL	6
			22594-8	NUT, HEX	70	1	240641-1	SPACER, SHEAR BLADE	5
			240628-1	PLATE, ADJ	69	1	233009-1	SPACER, TUBULAR	4
			240626-1	SHAFT, PIVOT	68	1	2-456134-0	CRIMPER, INSULATION	3
			240633-1	BUSHING	67	1	455888-1	SPACER, INSULATION	2
			455680-1	LEVER, INTERMEDIATE	66	1	1-456403-3	CRIMPER, WIRE	1
			240629-1	BLOCK, PIVOT	65				
			240632-2	SCREW, ADJ	64				
			240659-3	PIN, CAM ROLLER	63				
			240658-1	CAM, ROLLER	62				
		REF	454398-1	ROD, FEED	61				
				60					

QTY	PART NO	DESCRIPTION	ITEM NO
		BTN HD SOC CAP SCR 3/8-16 X 75 (REF)	

REMARKS		NO	REV
APPL USED ON MACHINE PART NO		TO APPLY TERMINAL	
CUSTOMER NAME	APPL SERIAL NO	DISTRIBUTION	
ADDRESS	PURCHASE ORDER	ORIGINAL	
CITY	ENG APP	CUSTOMER COPY	
		FIELD ENG COPY	

CRIMP	SIZE	TYPE	FEED	APPL INST
WIRE	062	F	680	A18039
INSUL	100	F		

WIRE RANGE: 24-20    INSULATION RANGE: 040-080    PRESS NO: 565735-5

REMARKS: AMP-O-LECTRIC PRE FEED

SETUP PAGE 10-1  
453635-1434  
7/16/78 APP 7/16/78  
D. DUBO 6495-75  
ECN A15788A  
REV PER ECN R5477  
REV PER ECN R2510

AMP INCORPORATED  
Harrisburg, Pa.

LOC A D NO 456204-2 REV D

NAME: MINIATURE QUICK CHANGE APPLICATOR  
END FEED (AMP BLADE)