

SIGN	DATE	DESCRIPTION	APPROVER
THIS IS CAD DRAWING, DO NOT REVISE MANUALLY!!!			

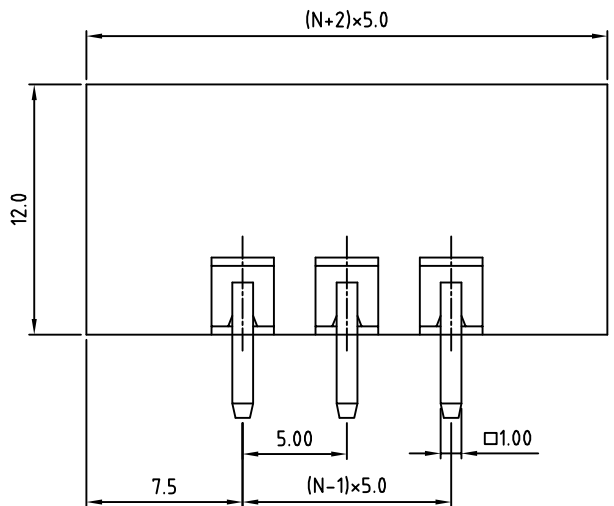

N = Number of contacts
P.C.B LAYOUT

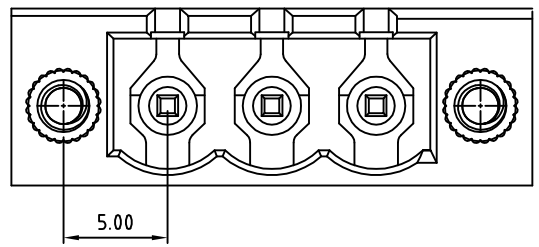
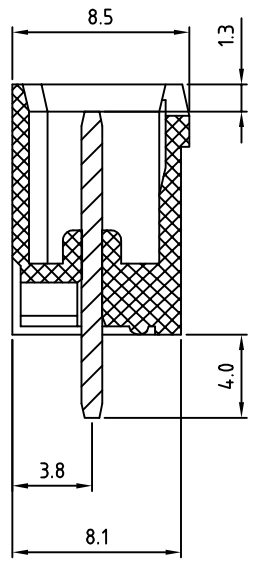

- Material**
- Terminal body
(contact pin): Brass(CuZn) Tin plated
 - With flange nut: Brass M2.5
 - Insulator (housing): Thermoplastic (UL94V-0)
- Electrical** cULus/VDE/TUV
- Voltage rating: 300VAC/300VAC/300VAC
 - Current rating: 20A/20A/20A
 - Withstanding Voltage: 1.6KV/2.5KV/2.5KV
 - Operating temperature: -30°C to +105°C
 - Soldering temperature: 250°C±10°C/5 Sec
 - Safety Approval:

RoHS Compliant

PART NUMBER:

OSTOQXX7550

- No. of Poles
- 02: 2 Poles
 - ...
 - 24: 24 Poles
- COLOR
- 0: Black
 - 5: Green (Standard)
 - 6: Blue
 - 8: Grey

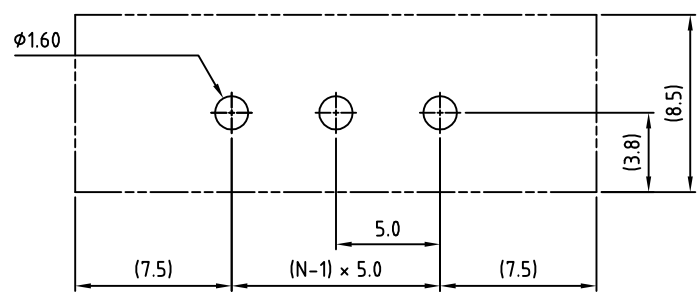

THESE DRAWINGS AND SPECIFICATIONS ARE THE PROPERTY OF ON-SHORE TECHNOLOGY, INC. AND SHALL NOT BE REPRODUCED, COPIED OR USED IN ANY MANNER WITHOUT THE PRIOR WRITTEN CONSENT OF ON-SHORE TECHNOLOGY, INC.



TITLE								OSTOQ 5.0mm series W/F vertical 2p-24p	
PART NO.		OSTOQXX7550		DWG NO.		OSTOQXX7550.DWG		A	
APPROVED		CHECKED	DESIGNED	DRAWN	CUST NO.		Tolerance		
Shi Jun 2006.11.01		Marvin 2006.11.01	Marvin 2006.11.01	Steady 2006.11.01			X. ±0.50		
							X.X ±0.30		
							X.XX ±0.10		
							X° ±1°		
					SHEET: 01/01		REV.: G		