

SPRING-LOADED PINS

DISCRETE SPRING-LOADED CONTACTS

0965

0965-0-15-20-80-14-11-0

Ultra low profile, Surface mount
* Stainless steel spring

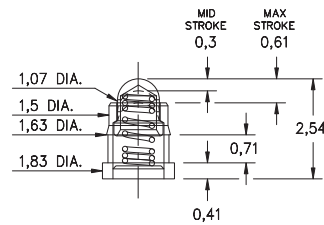

0921-0

0921-0-15-20-76-14-11-0

Ultra low profile, Short stroke. Solder mount in 1,78 min. mounting hole
Also available on 24mm wide carrier tape: 1,700 parts per 330mm reel
Order as: 0921-0-57-20-76-14-11-0

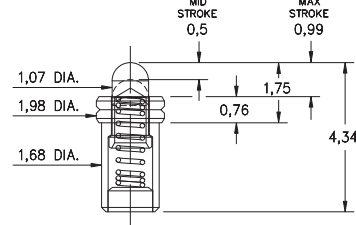

0921-1

0921-1-15-20-7X-14-11-0

Low profile, Standard stroke
Solder mount in 1,78 min. mounting hole

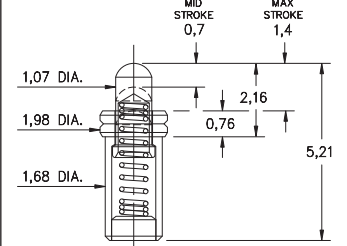

0926-0

0926-0-15-20-76-14-11-0

Low Profile, Short Stroke
Solder mount in 1,88 min. mounting hole

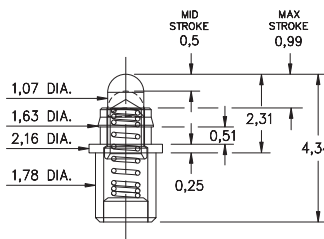

0926-1

0926-1-15-20-75-14-11-0

Low profile, Standard stroke
Solder mount in 1,88 min. mounting hole

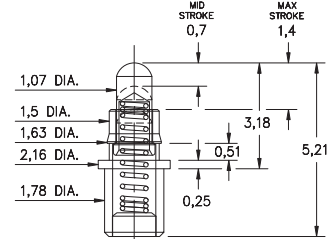

0977

0977-0-15-20-7X-14-11-0

Standard stroke, Surface mount
Also available on 24mm wide carrier tape: 1,100 parts per 330mm reel
Order as: 0977-0-57-20-75-14-11-0

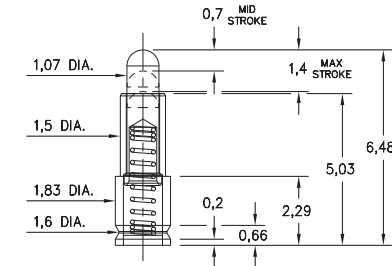

0911

0911-0-15-20-86-14-11-0

Standard stroke, Surface mount
* Stainless steel spring

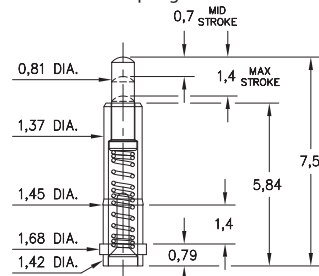

0980

0980-0-15-20-7X-14-11-0

Double action, 1,4 Combined stroke
Mount between parallel circuit boards

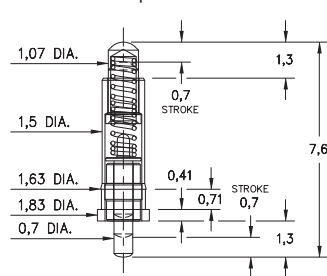

0959

0959-0-54-20-7X-14-11-0

Receptacle spring pin, Standard stroke
Accepts 0,51 - 0,81 Dia. pins

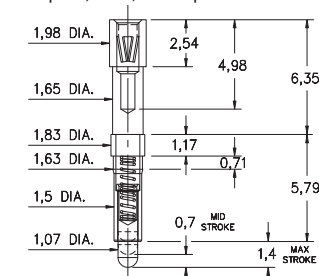

0919

0919-0-15-20-89-14-11-0

3mm Long stroke, Surface mount
* Stainless steel spring

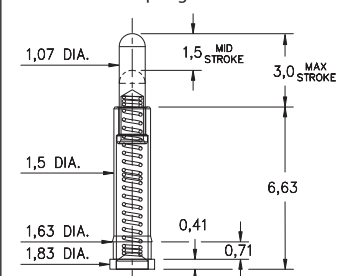

Material Specifications:

Sleeve & Plunger Material: Copper Alloy
Spring Material: BeCu or Stainless Steel 302 *
Sleeve & Plunger Finish: 0,5µm Gold over Nickel
Spring Finish: 0,25µm Gold over Nickel
Dimensions: Millimeters
Tolerances On: Lengths: ± 0,15
Diameters: ± 0,051
Angles: ± 2°



Mechanical & Electrical Specifications:

Durability: 1,000,000 cycles
Current Rating: 2A continuous, 3A peak
Contact Resistance: 20 mΩ max.
Environmental Specifications:
Operating temperature range: -55/+125°C

75, 76, 80, 85, 86, 89 Springs are not interchangeable

Order Code: 09XX - X - 15 - 20 - **XX** - 14 - 11 - 0

Spring Number

Spring Number	Mid. Stroke	Max. Stroke	Force @ Mid. Stroke	Initial Force (Pre-Load)
75	0,7	1,4	60 g	25 g
76	0,5	0,99	60 g	25 g
80	0,3	0,61	70 g	25 g
85	1,02	2,03	60 g	25 g
86	0,7	1,4	60 g	25 g
89	1,5	3,0	85 g	25 g

