

LAYOUT DIMENSIONS (after plating)  
CONNECTOR SIDE VIEW

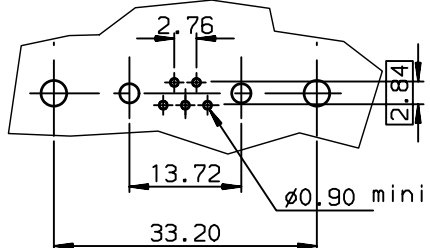

TIN LEAD PART NUMBER

DAV7W2S300G30	UNC 4.40
DAI7W2S300G30	M3
PART NUMBER	Threaded A

LEAD FREE PART NUMBER

DAV7W2S300G30LF	UNC 4.40
DAI7W2S300G30LF	M3
PART NUMBER	Threaded A

GENERAL CHARACTERISTICS AND ROHS INFORMATIONS:  
SEE DRAWING C01-8639-0001

European Views

www.fciconnect.com		surface ISO 1302	tolerance std ISO 406 ISO 1101	projection mm	size A3		Scale 1.5	
TOLERANCES UNLESS OTHERWISE SPECIFIED				ANGULAR	0.X	±0.1	ECN L506-0095	
				LINEAR	0.XX	±0.1		
				0.XX' ±2'	0.XXX	±0.1		
Dr	JARRY	2001/01/05	Product family		D-SUB	Spec ref -		
Eng	PESSON	2001/01/05	SOCKET CONNECTOR WITH					Rev. D
Chr	LEGARE	2001/01/05	TWO POWERS CONTACTS					
Appr	LEGARE	2001/01/05	C01-8639-1802					
rev	ecn no	dr	date	catalog no		CUSTOMER sheet 1 of 1		
B	-	DEB	2003/10/01	-		-		
C	L505-001	MPE	2005/03/09	-		-		
D	L506-0095	LGO	2006/06/27	-		-		

rev	ecn no	dr	date
B	-	DEB	2003/10/01
C	L505-001	MPE	2005/03/09
D	L506-0095	LGO	2006/06/27
-	-	-	-
-	-	-	-
-	-	-	-
-	-	-	-

