

THIS DRAWING IS UNPUBLISHED. RELEASED FOR PUBLICATION  
 © COPYRIGHT BY TYCO ELECTRONICS CORPORATION. ALL INTERNATIONAL RIGHTS RESERVED.

LOC	DIST	REVISIONS					
FT	0	P	LTR	DESCRIPTION	DATE	DWN	APVD
			C	REVISED PER ECO-10-013617	26JUL10	HMR	CR

**MATERIAL:**  
 HOUSING: THERMOPLASTIC, UL94V-0, BLACK.  
 TERMINALS: BRIGHT TIN OVER COPPER ALLOY.  
 SCREWS: #6-32 STEEL, ZINC PLATING W/ CLEAR CHROMATE.

**ELECTRICAL:**  
 RATED CURRENT UL/CSA:  
 CLASS C: 20A, 300V.  
 CLASS D: 5A, 600V.  
 WIRE RANGE: 12-22 AWG

**MECHANICAL:**  
 RECOMMENDED TORQUE: 7 IN-LB.  
 OPERATING TEMP.: 105°C MAX.

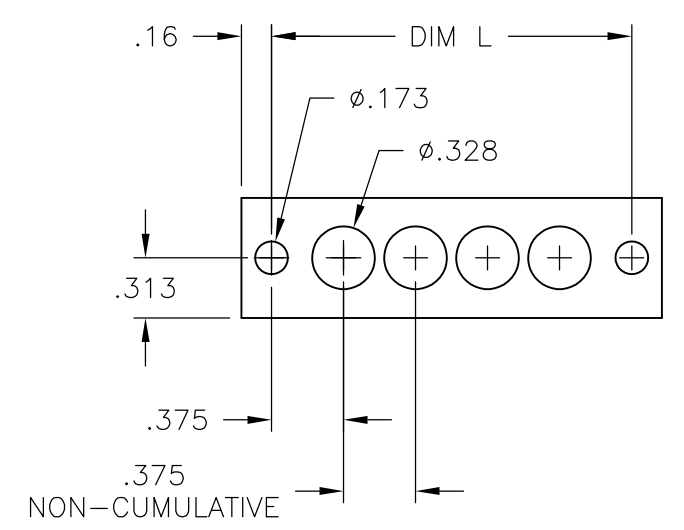
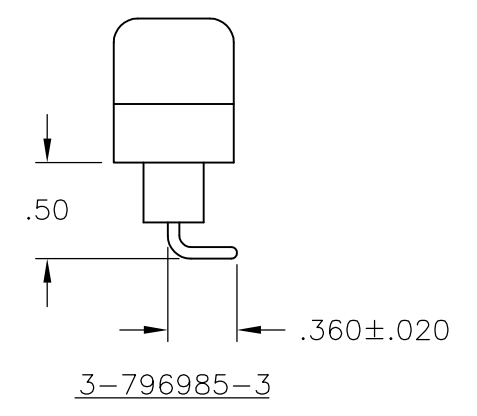
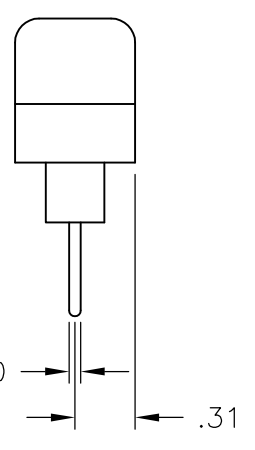
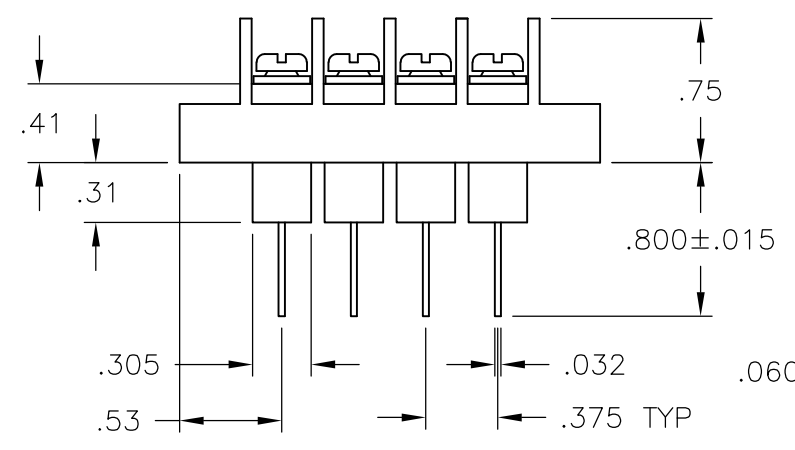
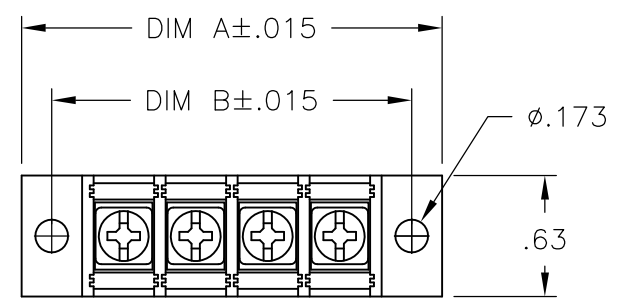

MOUNTING PANEL LAYOUT

9.000	9.314	23	JC6-W308-23	5-1546702-8
8.625	8.939	22	JC6-W308-22	5-1546702-7
8.250	8.564	21	JC6-W308-21	5-1546702-6
7.875	8.189	20	JC6-W308-20	5-1546702-5
7.500	7.814	19	JC6-W308-19	5-1546702-4
7.125	7.439	18	JC6-W308-18	5-1546702-3
6.750	7.064	17	JC6-W308-17	5-1546702-2
6.375	6.689	16	JC6-W308-16	5-1546702-1
6.000	6.314	15	JC6-W308-15	5-1546702-0
5.625	5.939	14	JC6-W308-14	3-1437666-8
5.250	5.564	13	JC6-W308-13	4-1546702-9
4.875	5.189	12	JC6-W308-12	6-1437666-8
4.500	4.814	11	JC6-W308-11	4-1546702-8
4.125	4.439	10	JC6-W308-10	4-1546702-7
3.750	4.064	9	JC6-W308-09	4-1546702-6
3.375	3.689	8	JC6-W308-08	3-1437666-7
3.000	3.314	7	JC6-W308-07	4-1546702-5
2.625	2.939	6	JC6-W308-06	4-1546702-4
2.250	2.564	5	JC6-W308-05	3-1437666-6
1.875	2.189	4	JC6-W308-04	4-1546702-3
1.500	1.814	3	JC6-W308-03-177	3-796985-3
1.500	1.814	3	JC6-W308-03	4-1546702-2
1.125	1.439	2	JC6-W308-02	3-1437666-5

SEE FIGURE

THIS DRAWING IS A CONTROLLED DOCUMENT.		DWN S. SCHLEGEL 5/27/03	Tyco Electronics Corporation Harrisburg, PA 17105-3608			
DIMENSIONS: INCHES		CHK S. YODER 5/27/03				
TOLERANCES UNLESS OTHERWISE SPECIFIED:		APVD S. YODER 5/27/03	NAME			
0 PLC ± - 1 PLC ± - 2 PLC ± .01 3 PLC ± .005 4 PLC ± - ANGLES ± -		PRODUCT SPEC	JC6-W308-XX ASSEMBLY			
MATERIAL		APPLICATION SPEC	SIZE	CAGE CODE	DRAWING NO	RESTRICTED TO
FINISH		WEIGHT	A3	00779	C-3-1437666-5	-
CUSTOMER DRAWING			SCALE	SHEET	REV	
			NTS	1 OF 1	C	