

PART NUMBER	REV	FIRST USED	POWER UNIT	FEED TYPE	DESCRIPTION
1855380-1	A	122500-1	LEADMAKER	POST FEED	CUTS CARRIER
1855380-2	A	565435-5	BENCH MODEL K	PRE FEED	CUTS CARRIER
1855380-3	A	354500-1	BENCH MODEL G	PRE FEED	CUTS CARRIER
1855380-6	A	122500-1	LEADMAKER	POST FEED	CONTINUOUS CARRIER
7-1855380-7	A	-	-	-	SPARE PARTS

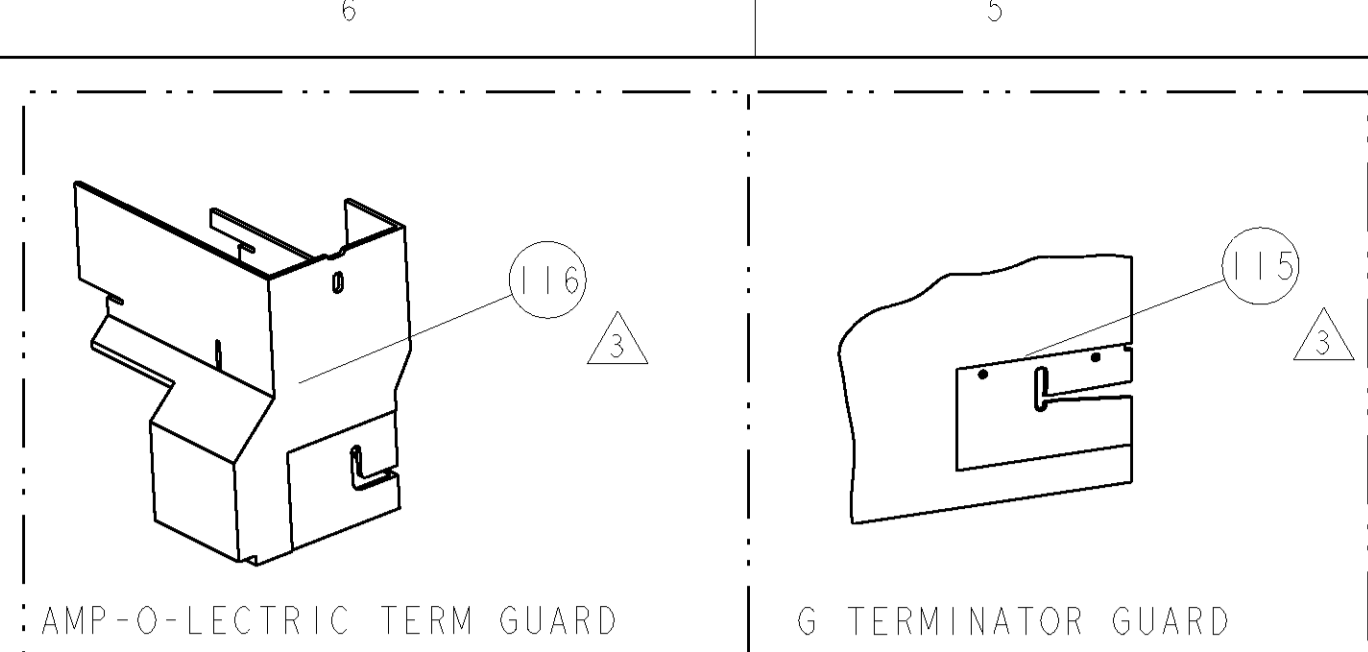

TE PN		COMP PN	SUMITOMO TERMINAL - TE CRIMP SPECS		REF SETTING
1572445	-	8240-4992	CRIMP HEIGHT	WIRE SIZE	C9
-	-	-	1.20mm+.05/- .05 [ .047+.002/- .002 ]	1mm2	D4
-	-	-	1.14mm+.05/- .05 [ .045+.002/- .002 ]	18AWG or 0.8mm2	-
TE SEAL	COMP SEAL	CRIMP	SIZE	TYPE	RANGE
1572448-1	7165-0194	WIRE	2.29mm [ .090 ]	F	.80mm-1mm
1572081-1	7165-0118	INSUL	3.81mm [ .150 ]	O	∅ 3.300 MAX [ 5 ]
WIRE STRIP LENGTH	TERM APPL SPEC	FEED	APPLICATOR INSTRUCTIONS		SET UP GAGE
4.550-4.980	NONE	12.570	408-8040		458637-1

LOC	DIST	REV	DESCRIPTION	DATE	DWN	APVD
A	66	A	RELEASED	04APR2008	BH	BH

- △ RECOMMENDED SPARE PARTS
- △ GREASE LIGHTLY
- △ GUARD MUST BE IN PLACE WHEN OPERATING APPLICATOR IN A BENCH MACHINE
- △ APPLY TORQ-SEAL IN ALLEN SOCKET TO FILL HOLE AFTER FLAT HD HAS BEEN ADJUSTED TO CORRECT HEIGHT AT QUALIFICATION. APPLY PN 1-23419-5 LOC-TITE TO THREADS.
- △ THE INSULATION RANGE LISTED IS FOR THE SEAL. THE INS. RANGE FOR SEAL #1572448-1 IS 1.5-2.0mm. THE INS. RANGE FOR SEAL #1572081-1 IS 1.7-2.4mm.

**\* WARNING**  
ON INSTALLATION, SET WIRE DISC TO LARGEST WIRE SIZE SETTING. USE OF SETTINGS BELOW MIN. REQUIRED CRIMP HEIGHT SETTING WILL CAUSE DAMAGE TO CRIMP TOOLING.

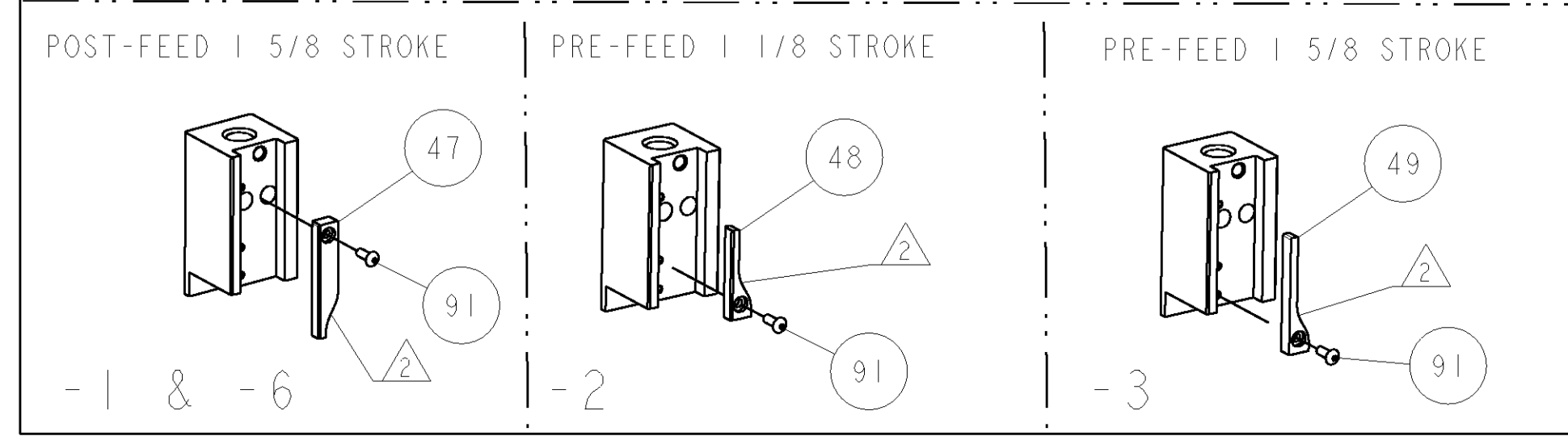
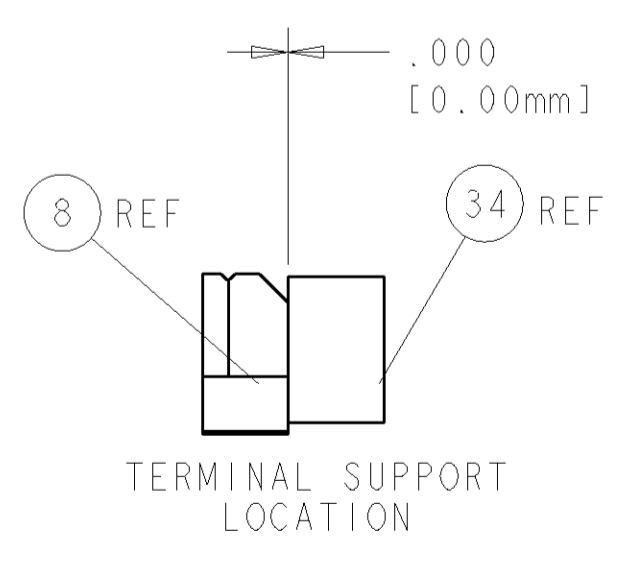
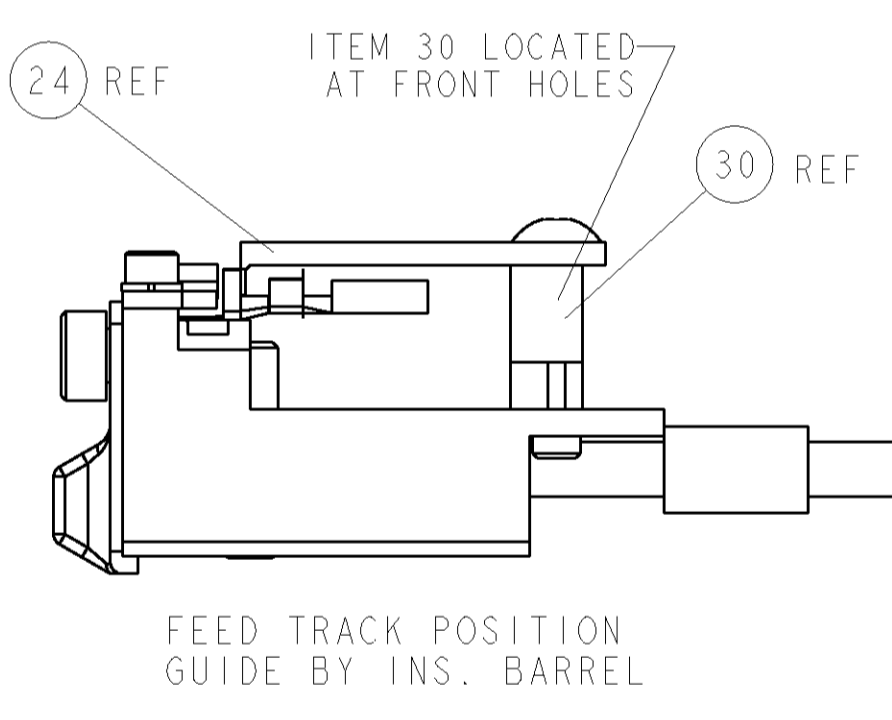
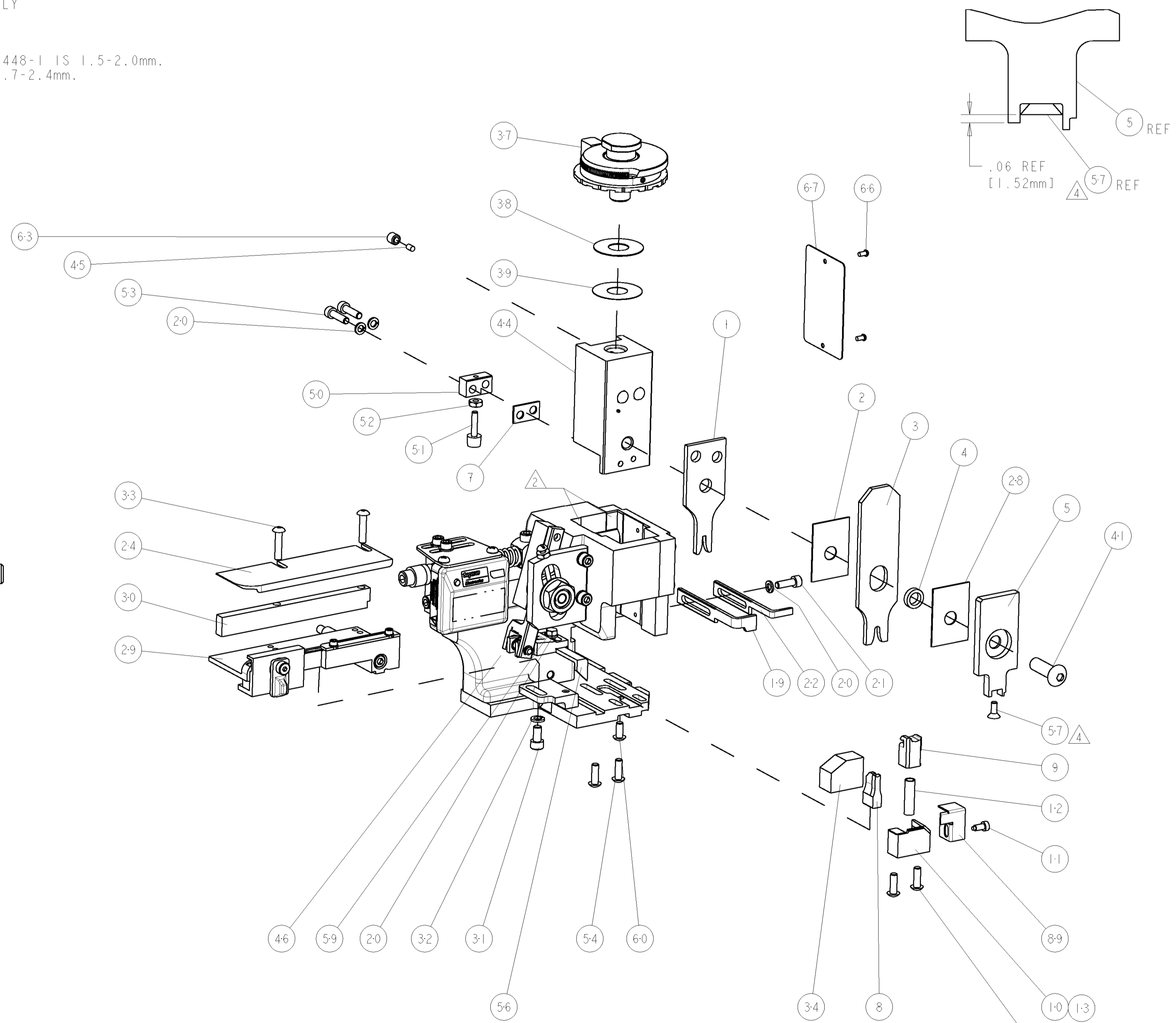

QTY	REF	DESCRIPTION	ITEM NO
-	-	REF	455749-1
-	-	REF	679532-1
-	1	SCR, BTN SKT HD CAP 6-32 X .375	91
-	1	GUARD, FRONT CHIP	89
-	1	SF APPL INST 408-8040	72
-	1	GENERAL INSTRUCTION PKG	71
-	1	PLATE, IDENTIFICATION	67
-	2	SCREW, DRIVE	66
-	1	SCR, SET, SELF LOCKING 1/4-20 X .250	63
-	1	SCR, BHSC, SELF-LOCKING, 8-32 X .375	60
-	1	SCR, HEX HD CAP 8-32 X .312	59
-	1	SCR, FLT SKT HD CAP 6-32 X .375	57
-	1	PAWL, FEED	56
-	4	SCR, BTN SKT HD CAP 8-32 X .500	54
-	2	SCR, SKT HD CAP 8-32 X .625	53
-	1	NUT, HEX, REG 6-32	52
-	1	BUMPER, HOLD DOWN	51
-	1	SPACER, TONKER	50
-	-	CAM, PRE FEED, 1 5/8	49
-	-	CAM, PRE FEED, 1 1/8	48
-	-	CAM, POST FEED, 1 5/8	47
-	-	APPL. BASIC SUB ASSY (SIDE WISE MOCA)	46
-	-	PLUG, NYLON	45
-	-	RAM, SIDE FEED	44
-	-	SCR, BTN SKT HD CAP 5/16-24 X 1.00	41
-	-	SHIM SUB-ASSY	39
-	-	SHIM	38
-	-	FINE ADJUST HEAD ASSEMBLY	37
-	-	TERMINAL SUPPORT	34
-	2	SCR, BTN SKT HD CAP 8-32 X .750	33
-	-	WASHER, SPRG LOCK, REG NO 10	32
-	-	SCR, SKT HD CAP 10-32 X .375	31
-	-	SPACER, STRIP GUIDE	30
-	-	ASSEMBLY, STRIP GUIDE	29
-	-	SPACER, CRIMPER	28
-	-	PLATE, STRIP GUIDE	24
-	-	STRIPPER	22
-	-	SCR, SKT HD CAP 8-32 X .500	21
-	4	WASHER, SPRG LOCK, REG NO 8	20
-	-	STRIPPER	19
-	-	SHEAR HOLDER, FRONT (NO CUT)	13
-	-	SPRING, COMPRESSION	12
-	-	STOP, SHEAR	11
-	-	SHEAR HOLDER, FRONT	10
-	-	FLOATING SHEAR, FRONT	9
-	-	ANVIL, COMBINATION .090	8
-	-	SPACER	7
-	-	-	6
-	-	DEPRESSOR, SHEAR	5
-	-	BLOCK, CRIMPER SPACER	4
-	-	CRIMPER, INSUL O PREMIUM	3
-	-	SPACER, CRIMPER	2
-	-	CRIMPER, WIRE PREMIUM	1

DIMENSIONS:		TOLERANCES UNLESS OTHERWISE SPECIFIED:		MATERIAL:		FINISH:	
INCHES	9 PLC ±.01	PLC	±.01	PLC	±.01	PLC	±.01
	1 PLC ±.01	PLC	±.01	PLC	±.01	PLC	±.01
	3 PLC ±.001	PLC	±.001	PLC	±.001	PLC	±.001
	4 PLC ±.0001	PLC	±.0001	PLC	±.0001	PLC	±.0001
	ANGLES ±.0001	PLC	±.0001	PLC	±.0001	PLC	±.0001

CUSTOMER VIEWABLE ASSEMBLY